

221 - CÔMODA SAPATEIRA SOLE

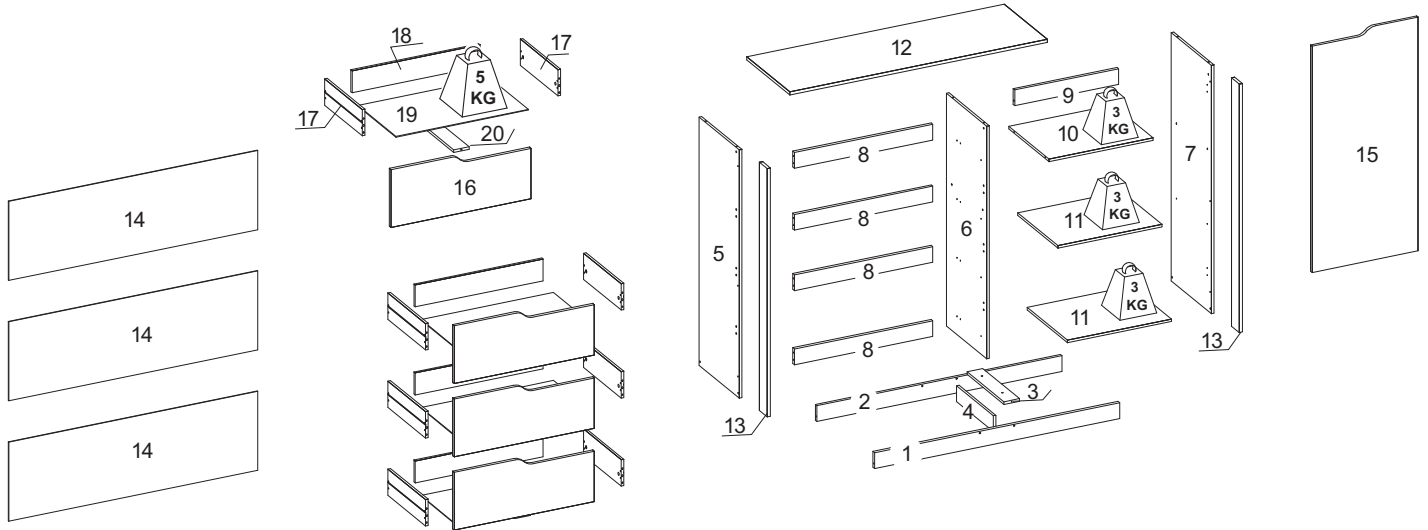

LISTA DE PEÇAS / Pieces List / Lista de Piezas

SEQ.	REF.	DESCRIÇÃO	DESCRIPTION	DESCRIPCIÓN	MAT.PRIMA	COMP.	LARG.	ESP.	QTD.
1	332019	Rodape Traseiro	Back footer	Pie de página posterior	MDP	1142	72	15	1
2	332020	Rodape Frontal	Front footer	Pie de página frontal	MDP	1142	72	15	1
3	332021	Trava Divisoria	Partition lock	Bloqueo de partición	MDP	343	72	12	1
4	332022	Trava Rodape	Footer lock	Bloqueo de pie de página	MDP	343	72	12	1
5	332023	Lateral Esquerda	Left side	Lado izquierdo	MDP	1135	375	12	1
6	332024	Divisoria	Divider	Divisor	MDP	1063	375	12	1
7	332025	Lateral Direita	Right side	Lado derecho	MDP	1135	375	12	1
8	332026	Vista Gaveta	Drawer view	Vista del cajón	MDP	645	72	15	4
9	332027	Vista Gaveta Menor	Drawer view smaller	Vista del cajón más pequeño	MDP	485	72	15	1
10	332028	Prateleira	Shelf	Estante	MDP	485	375	12	1
11	332029	Prateleira Movei	Mobile shelf	estantería móvil	MDP	485	375	12	2
12	332030	Tampo	Cover	Cubrir	MDP	1200	400	15	1
13	332031	Vista Lateral	Side view	Vista lateral	MDP	1135	72	15	2
14	332032	Fundo	Bottom	Abajo	HDF	1160	362	3	3
15	332033	Porta	Door	Puerta	MDP	1068	494	15	1
16	332034	Frente De Gaveta Esquerda	Drawer front left	Frente del cajón izquierda	MDP	653	264	15	4
17	332035	Lateral De Gaveta	Drawer side	Lado del cajón	MDP	350	120	12	8
18	332036	Contra Fundo	Against background	Contra el fondo	MDP	596	100	12	4
19	332037	Fundo Da Gaveta	Drawer bottom	Fondo del cajón	HDF	618	355	3	4
20	332038	Apoio De Gaveta	Drawer support	Soporte de cajón	MDP	350	72	12	4

INSTRUÇÃO MONTAGEM PRODUTO
 Intructions to Assembly / Instrucciones de montaje

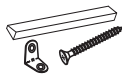

Separe as peças e acessórios de maneira organizada
 Separate parts and accessories in way organized
 Separe las piezas y accesorios de manera organizada

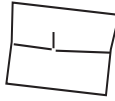

Forrar o chão com o papelão das embalagens.
 Cover the floor with the cardboard
 Cubra el suelo con la embalaje de cartón



É necessário 1 pessoa para montar o produto
 01 people are required to assemble the product
 Se requieren 01 persona para ensamblar el producto

O produto deve ser a montado por um profissional qualificado
 The product must be assembly by a professional
 El producto debe ser ensamblado por un professional calificado

Ferramentas necessárias
 (não fornecidas)

Not include tools / No herramientas



CUIDADO PARA CONSERVAÇÃO E LIMPEZA DO MÓVEL
 Care to conservation and clean / Cuidados de limpieza

Peso máximo de carga informado refere-se a objetos distribuido de maneira uniforme sobre toda área de contato da peça



The maximum load weight informed refers to objects distributed evenly over the entire contact area of the part
 Conjunto de carga máxima de peso se refiere a objetos distribuidos uniformemente sobre toda el área de contacto de la pieza de trabajo.



Não molhar o móvel e não expor em lugar úmido
 Do not wet the mobile and do not expose in a wet place
 No moje el producto y no exponer en un lugar húmedo



Não expor o móvel próximo de fontes de calor.
 Do not expose the mobile near heat sources
 no exponga cercano de fuentes de calor



Não usar produtos abrasivos.
 Do not use abrasive products.
 No utilice productos abrasivos.



Limpe com flanela limpa e seca.
 Clean with dry cloth
 Limpieza con un paño limpio y seco

LISTA DE ACESSÓRIOS E FERRAGENS / ACCESSORIES AND HARDWARE / ACCESORIOS Y HARDWARE



A- 700137-Parafuso 4,5x45 (26x)
 screw / tornillo



B- 700124-Parafuso 3,5x25 (26x)
 screw / tornillo



C- 700121-Parafuso 3,5x12 (150x)
 screw / tornillo



D- 700127 - Parafuso 4,0x12 (8x)
 screw / tornillo



E- 700130-Parafuso 4,0x16 (04x)
 screw / tornillo



F- 700146-Parafuso minifix (8x)
 Minifix screw /
 Tornillo minifix



G- 700148-Tambor Minifix (8x)
 Minifix Drum /
 Tambor minifix



H- 700542-Cavilha 6x30 (28x)
 peg / cerrojo



I- 700157-Prego (82x)
 nail / clavo

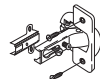

J - 700395 - Dobradiça (2x)
 700390 - Calço (2x)
 hinge / bisagra



K- 700516-Sache cola 20g (01x)
 Glue / Goma



L- 700441-Suporte prateleira(04x)
 shelf support/soporte de estantería



M- 703127-Perfil H (02x)
 Frame / Perfil



N- 700538-Cantoneira (04x)
 corner / esquina



O -700490 - 1 Kit com 6 pes (01x)
 wardrobe feet / alquiler de piso



P - 700113-Corrediça (04x)
 runners / corredera



Q - 700539-Cantoneira (10x)
 corner / esquina



R- 700419-Tapa furo minifix (24x)
 cover / tapa

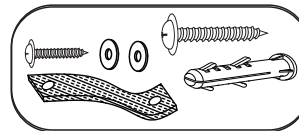

S- 703012 - Kit anti tonbamento (01x)
 Anti-tip kit / Kit antivuelco

01° PASSO - Fixar os acessórios nas peças 5 e 6

01° STEP - Fix accessory to parts 5 and 6

01° PASO - Fijar el accesorio las partes 5 y 6

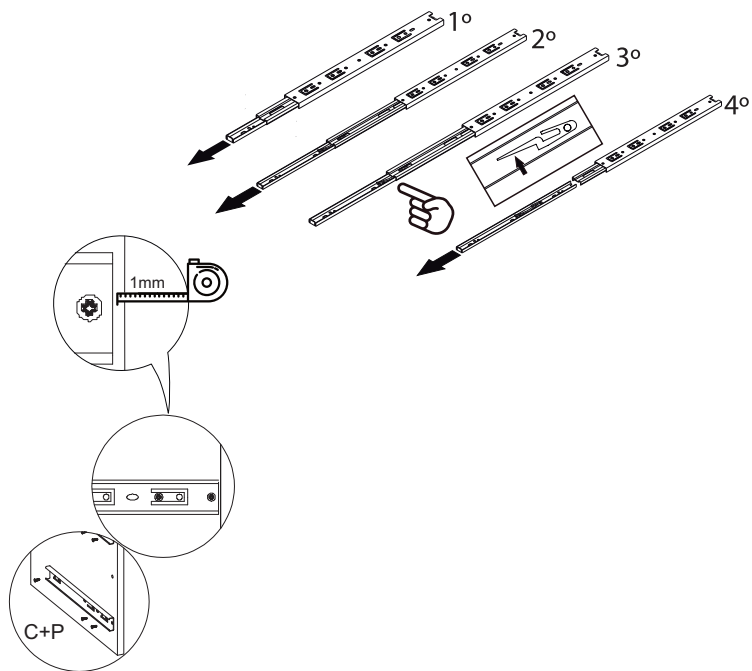
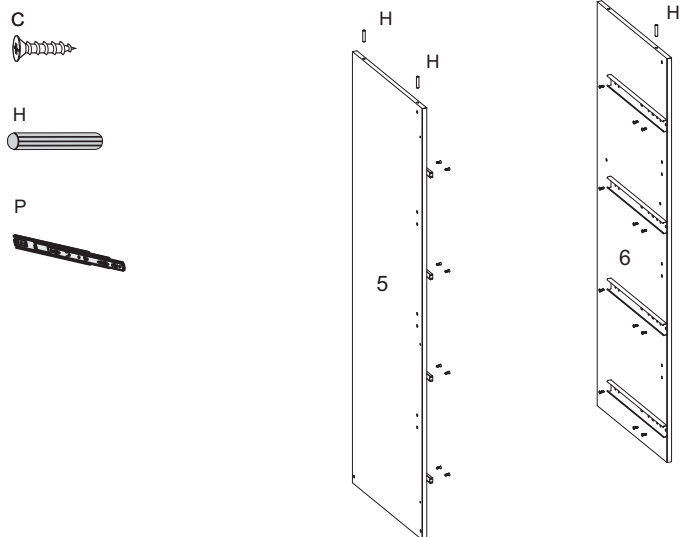

02° PASSO - Fixar peça 3 nas peças 1 e 2

02° STEP - Fix part 3 to parts 1 and 2

02° PASO - Fijar la pieza 3 a las piezas 1 y 2.

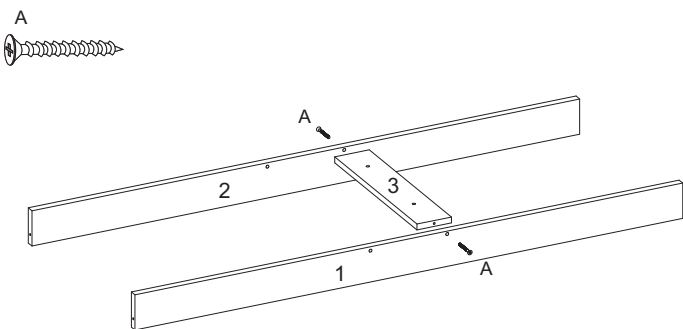

03° PASSO - Fixar as peças 5 e 7 nas peças 1 e 2.

03° STEP - Fijar parts 5 and 7 to parts 1 and 2.

03° PASO - Fijar las piezas 5 y 7 a las piezas 1 y 2.

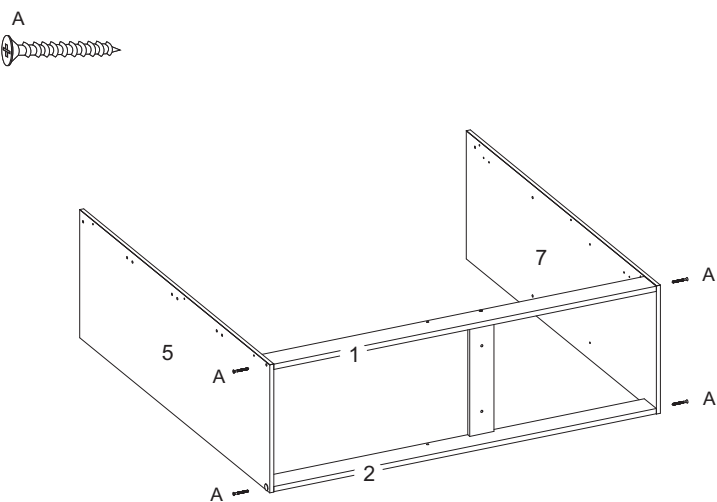

04° PASSO - Fixar a peça 4 nas peça 1 e 2

04° STEP - Fix part 4 to parts 1 and 2

04° PASO - Fijar la parte 4 a las partes 1 y 2

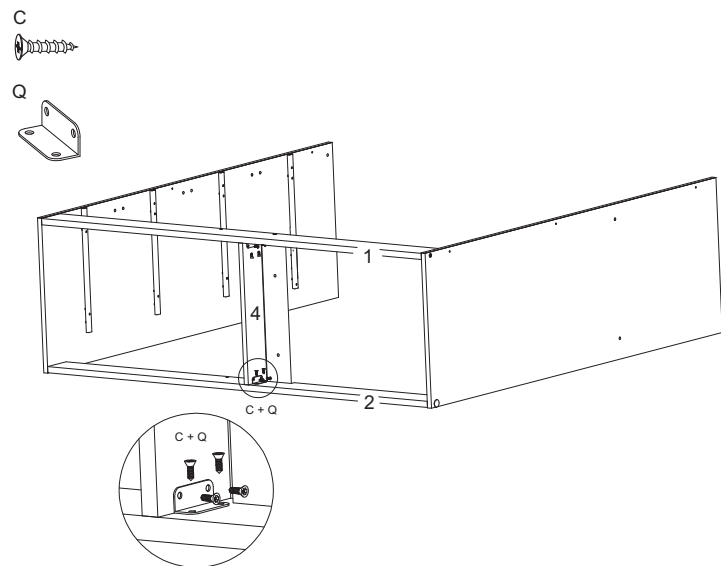

05° PASSO - Fixar o Kit pé

05° STEP - Fix the Foot Kit

05° PASO - Fijar el kit de pies

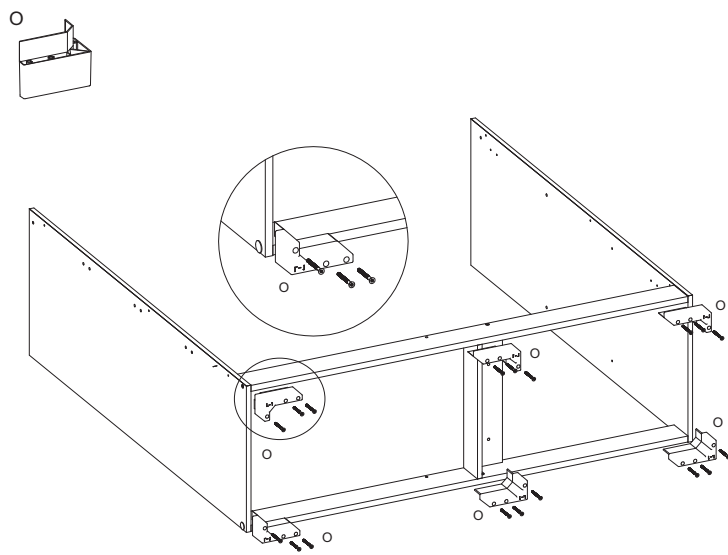

06° PASSO - Fixar a peça 6 na peça 3.

06° STEP - Fix part 6 to part 3.

06° PASO - Fijar la parte 6 a la parte 3.

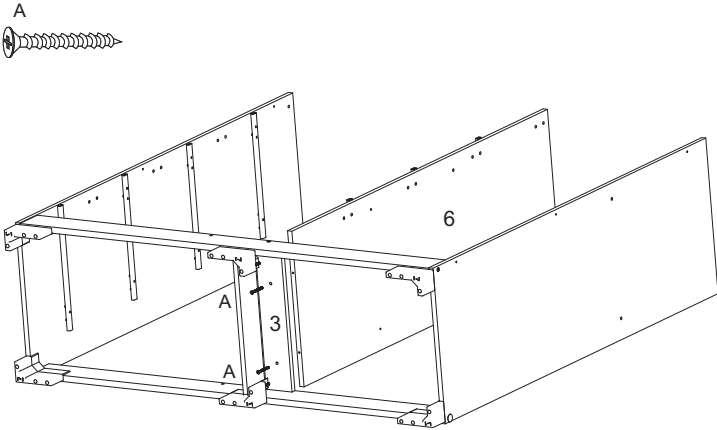

07° PASSO - Fixar a peça 8 nas peças 5 e 6 utilizando o acessório A.

07° STEP - Fix part 8 to parts 5 and 6 using accessory A.

07° PASO - Fijar la pieza 8 a las piezas 5 y 6 utilizando el accesorio A.

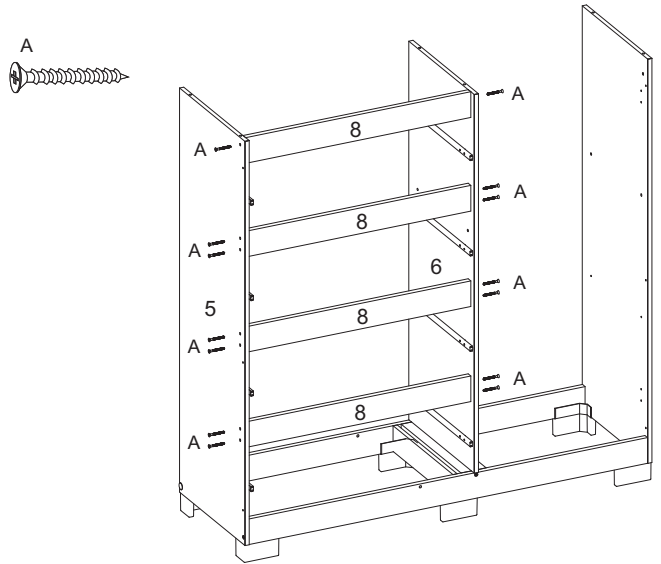

08° PASSO - Fixar peça 9 nas peças 6 e 7.

08° STEP - Fix part 9 to parts 6 and 7.

08° PASO - Fijar la parte 9 a las partes 6 y 7.

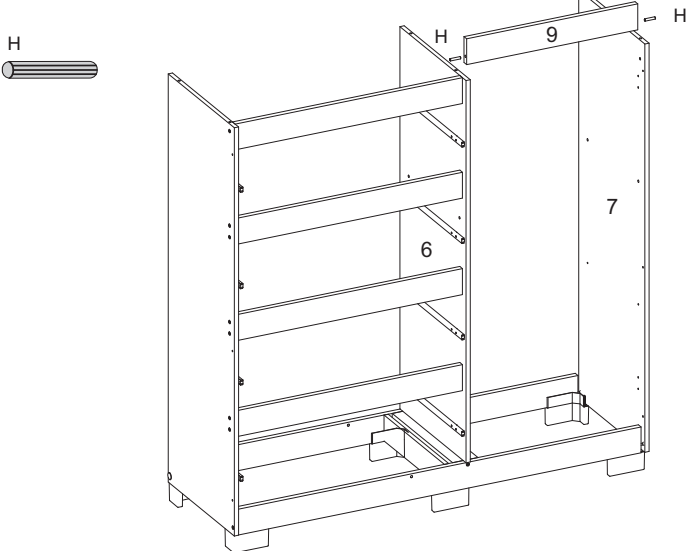

09° PASSO - Fixar a peça 12 nas peças 5, 6, 7, 8 e 9.

09° STEP - Fix part 12 to parts 5, 6, 7, 8 and 9.

09° PASO - Fijar part 12 to parts 5, 6, 7, 8 and 9.

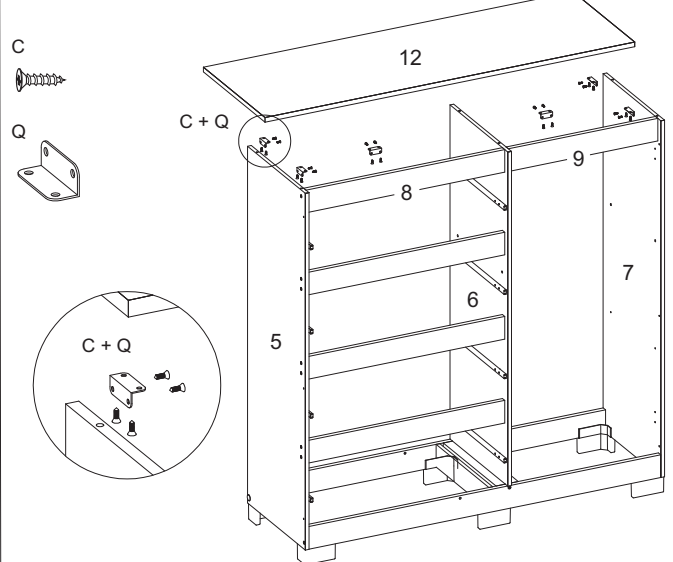

10° PASSO - Fixar a peça 10 nas peças 6 e 7 e encaixar a peça 11 nas peças 4, 6 e 7.

10° STEP - Fix part 10 to parts 6 and 7 and fit part 11 onto parts 6 and 7.

10° PASO - Fijar la pieza 10 a las piezas 6 y 7 y ajuste la pieza 11 a las piezas 6 y 7.

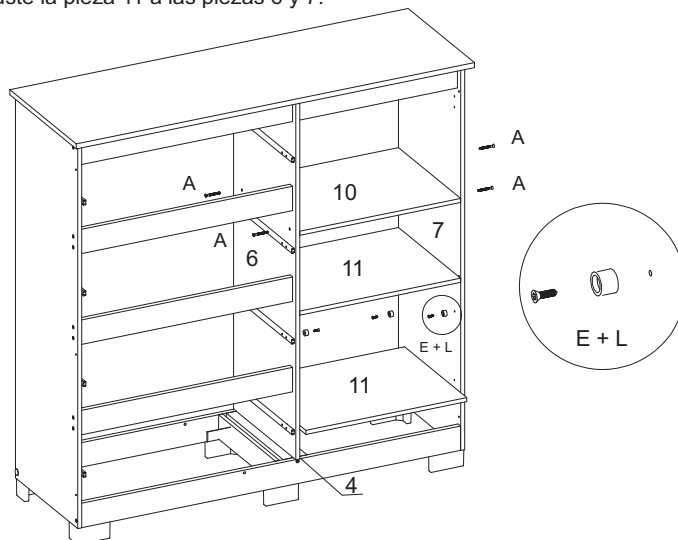
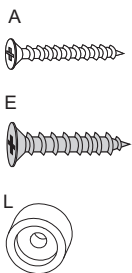

11° PASSO - Fixar a peça 13 nas peças 5 e 7.

11° STEP - Fix part 13 to parts 5 and 7.

11° PASO - Fijar la parte 13 a las partes 5 y 7.

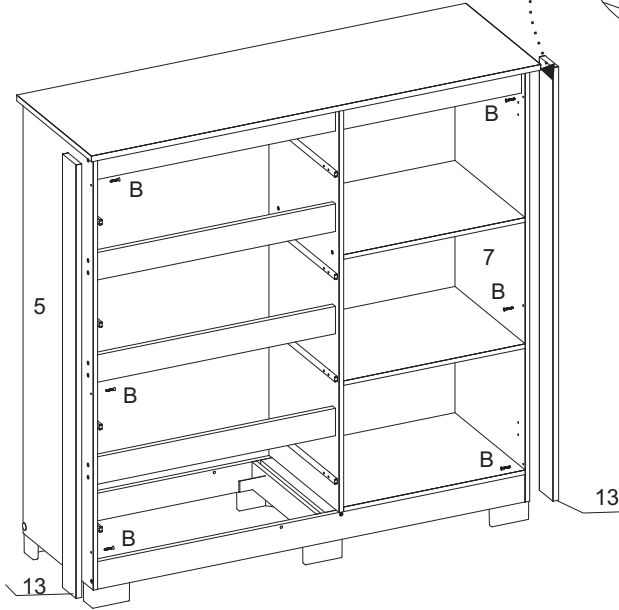

Alinhar a vista (peça 13) com a frente do tampo (peça 12)

Align the view (piece 13) with the front of the top (piece 12)

Alinee la vista (pieza 13) con el frente de la parte superior (pieza 12)

12° PASSO - Fixar peças 16 nas peças 17 e fixar peça 18 nas peças 17.

12° STEP - Fix part 16 to part 17 and attach part 18 to part 17.

12° PASO - Fijar la parte 16 a la parte 17 y la parte 18 a la parte 17.

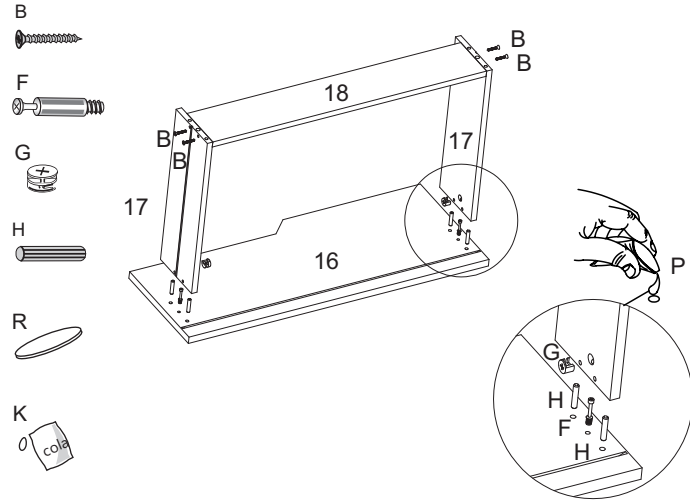

13° PASSO - Fixar a peça 19 nas peças 17 e 18.

13° STEP - Fix part 19 to parts 17 and 18.

13° PASO - Fijar la pieza 19 a las piezas 17 y 18.

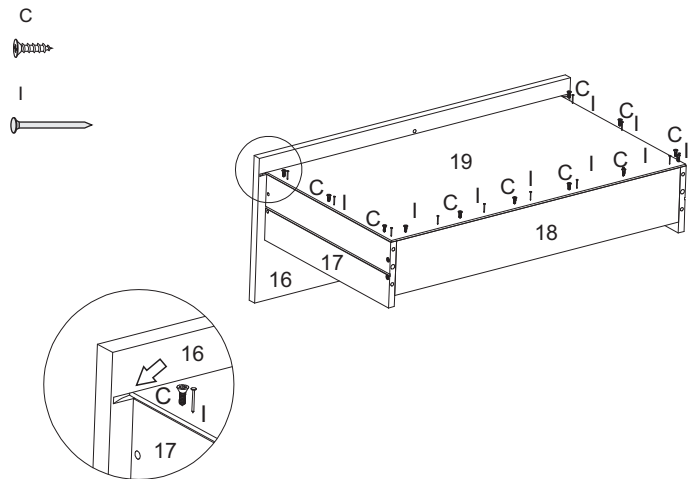

14° PASSO - Fixar a peça 20 nas peças 16, 18 e 19.

14° STEP - Fix part 20 to parts 16, 18 and 19.

14° PASO - Fijar la pieza 20 a las piezas 16, 18 y 19.

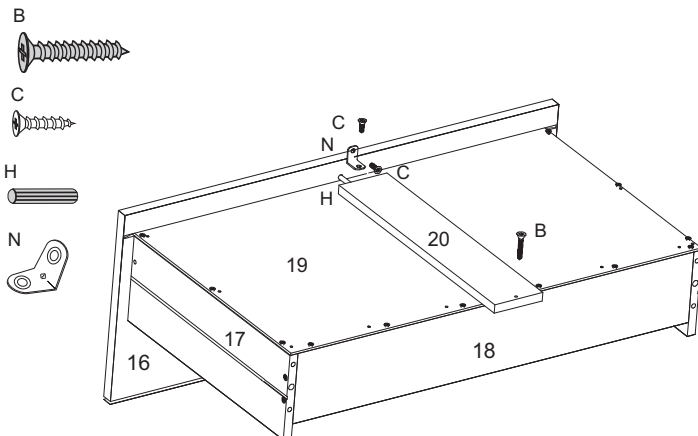

15° PASSO - Fixar o acessórios (C + P) nas peças 17.

15° STEP - Fix the accessories (C + P) to the parts 17.

15° PASO - Fijar los accesorios (C + P) en las piezas 17.

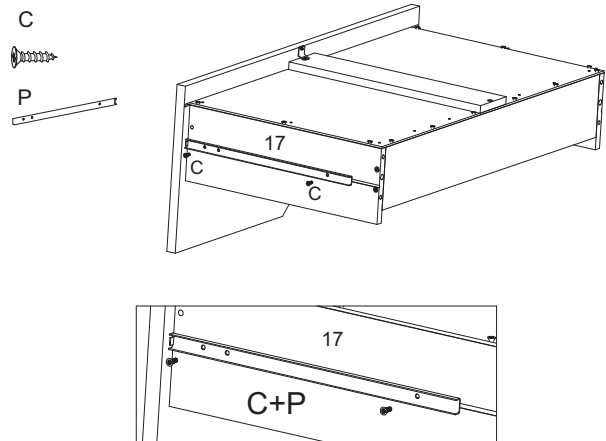

16° PASSO - Fixar peça 15 na peça 7 com os acessórios D + J.

16° STEP - Fix part 15 to part 7 with fittings D + J.

16° PASO - Fijar la pieza 15 a la pieza 7 con los racores D + J.

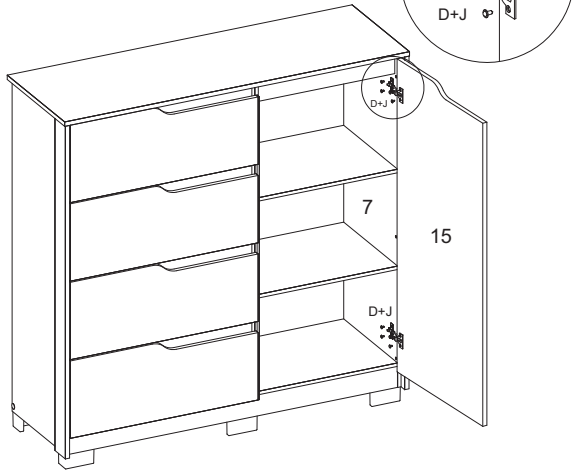
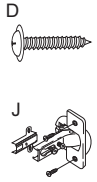

17° PASSO - Fixar peça 14 utilizando os acessórios I + M.

17° STEP - Fix part 14 using the I + M fittings.

17° PASO - Fijar la pieza 14 utilizando los racores I + M.

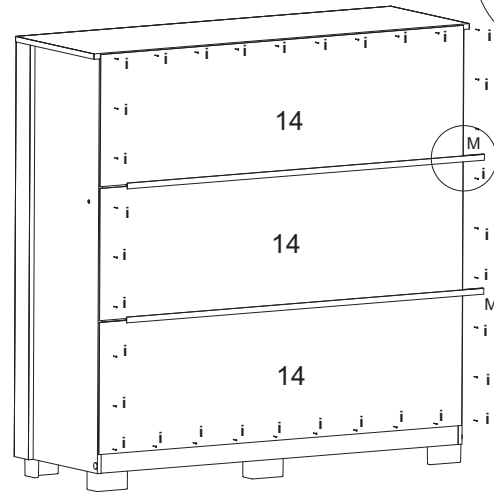

O produto contém um kit anti tombamento que deve ser fixado na parede e na parte traseira do produto
The product contains an anti-tip kit that must be fixed to the wall and back of the product
El producto contiene un kit antivuelco que debe fijarse a la pared y a la parte posterior del producto

S

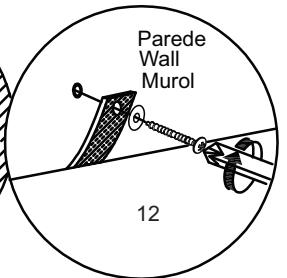
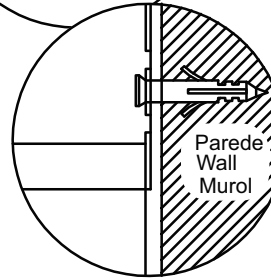
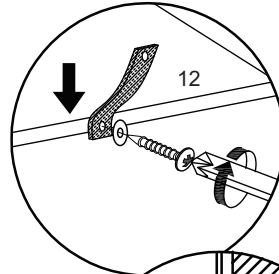
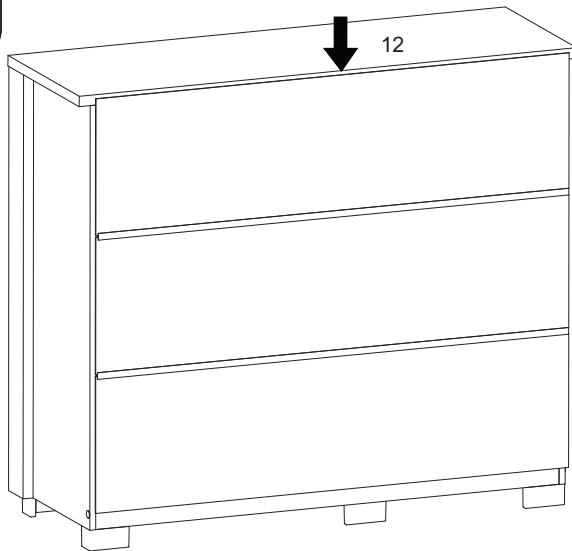
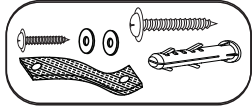

Aspecto final do produto

Final product aspect

Aspecto final del producto

